

Waveguide Broadwall Coupler



RLC Electronics offers a standard range of multi-hole broadwall directional couplers covering the frequencies from 40 GHz to 2.6 GHz in standard waveguide sizes. The electrical characteristics of high directivity and coupling

flatness are achieved by using a precise machined coupling hole pattern and a precision load in the secondary arm. Non standard configurations or selected electrical parameters are available on request.

WBC-1-2-3-4-5

Waveguide Size	Frequency	Dimensions		
		A	B	C
WR-28	26.50 - 40.00	9.00	1.25	0.90
WR-42	18.00 - 26.5	10.5	1.38	0.90
WR-62	12.40 - 18.00	12.5	2.00	1.00
WR-75	10.00 - 15.00	14.00	2.00	1.00
WR-90	8.20 - 12.40	17.00	2.00	1.25
WR-137	5.85 - 8.20	22.00	3.00	1.50
WR-284	2.60 - 3.95	46.00	6.50	2.50

VSWR: Primary: 1.1:1 max
Secondary: 1.15:1 max

Coupling values:
10, 20, 30, 40, 50 dB +/- 1 dB

Directivity: 35 dB min

Flange Type:

- 1 = Cover
- 2 = Choke
- 3 = CPRF
- 4 = CMR

To designate coupler,

- (1) Waveguide size
- (2) Coupling value
- (3) Flange 1

- (4) Input flange 2
- (5) Coupled output flange, or
R= SMA(f), N= N(f)

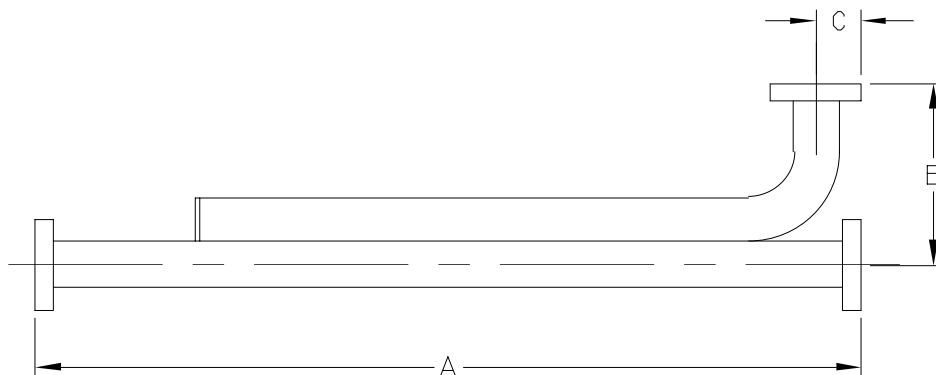

Specifications subject to change without notification.

Tolerances unless otherwise specified are .xx +/- .02, xxx +/- .005

Specials requiring closer tolerances, different frequency ranges, special connectors, different materials, finishes, etc. can be furnished upon request.



RLC ELECTRONICS, INC.

83 Radio Circle, Mount Kisco, New York 10549 Telephone 914-241-1334 Fax 914-241-1753
e-mail: sales@rlcelectronics.com www.rlcelectronics.com